

Dreamweaver & CSS: Page Properties

Page properties are a number of settings that are meant to apply to the page globally. In Dreamweaver things such as the default font, font size, font color, background, etc. are grouped together and accessed through the page properties button in the properties pane.

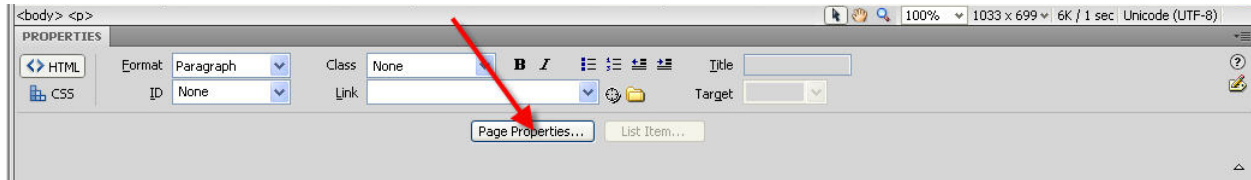

When you click the page properties button, the window will open in the Appearance (CSS) Category. This is a good place to start. Remember settings made here will become the default for the web page. Everything on the page will inherit these settings unless you specify that they should be different.

Appearance (CSS)

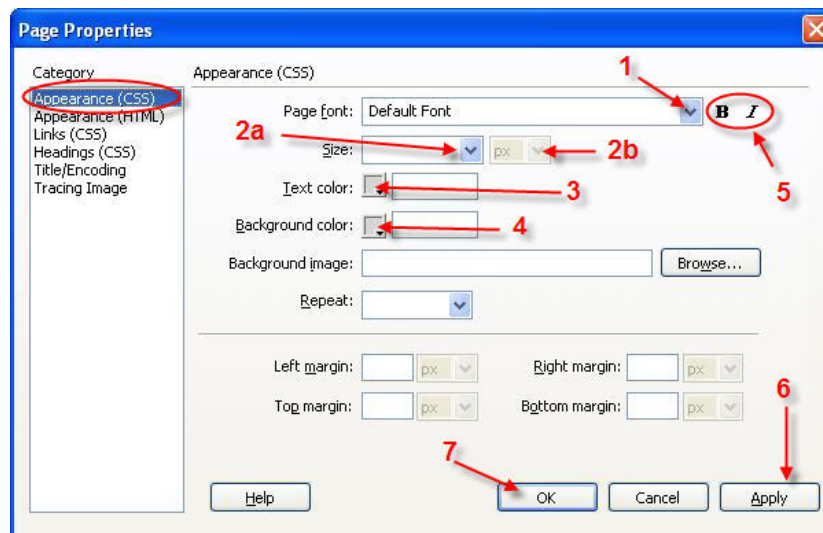

1. Choose the font scheme. The font displayed in a person's browser is dependent on the fonts installed on that computer. Therefore it is prudent to choose a common font here.
2. Font Size
 - a. Set the default size for the font on the page. Headings will be larger automatically.
 - b. Set the unit of measure for the font size – usually px, or ems
3. Choose the color for the text on the page
4. Choose a background color for the page if you wish
5. You may make the default font bold or italic here, but this is not recommended
6. You may use the apply button to see your changes without closing the window.
7. Choose OK when you are finished

Dreamweaver & CSS: Page Properties

Next try the Links (CSS) tab. It is in this window that you can pick the hyperlink colors and other formatting options. Remember, this will become the default for all hyperlinks on the page. You can change the appearance of some hyperlinks later by applying new css rules.

There are 4 different states that can occur related to hyperlinks, and each of these states can be formatted to appear differently. The "Link color" is the color of the hyperlink before it has been clicked. The "Visited color" is the color of the link if a person has previously selected that link. "Rollover links" also known as the hover state, occur when the mouse is over a hyperlink, but has not yet been clicked. "Active links" are the links that are currently selected.

Links (CSS)

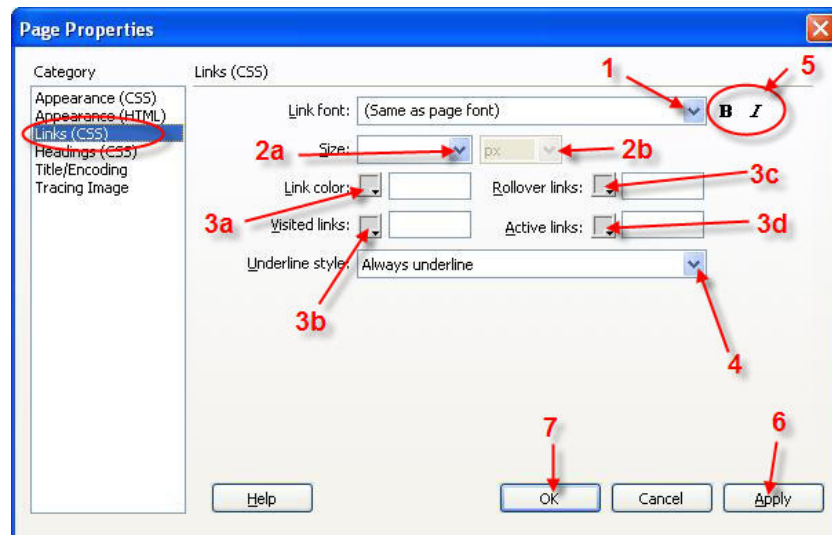

1. Choose an alternate font for hyperlinks if you wish. This setting will override the previous setting made on the appearance tab.
2. Choose the font size for hyperlinks
 - a. The size is entered here
 - b. The units are chosen here
3. Select colors for each possible hyperlink state
 - a. Set the link color is chosen here. Remember this is the color of "unvisited" links
 - b. Set the link color for visited links
 - c. Set the link color for the hover state
 - d. Set the link color for links in the active or selected state
4. Define how the "underline" on a hyperlink will be shown
5. Set all hyperlinks to be either bold, italic or both
6. You may test your settings without closing the window by selecting "Apply"
7. Click the "OK" button to close the window

Dreamweaver & CSS: Page Properties

Finally try the Headings (CSS) Category. Headings are assigned to text through the html <h1> to <h6> tags. A heading is used much the same as the heading in a text book. It identifies text as a label summarizing the main idea of the section that follows. In html an <h1> tag defines the highest level or most important heading. An <h2> heading would be considered of lesser importance – a subheading of <h1>. The same concept applies to each of the other heading tags. Using headings is important to communicate a web pages structure to your viewer. It is also used by search engines to determine the important concepts included in your web page.

Headings (CSS)

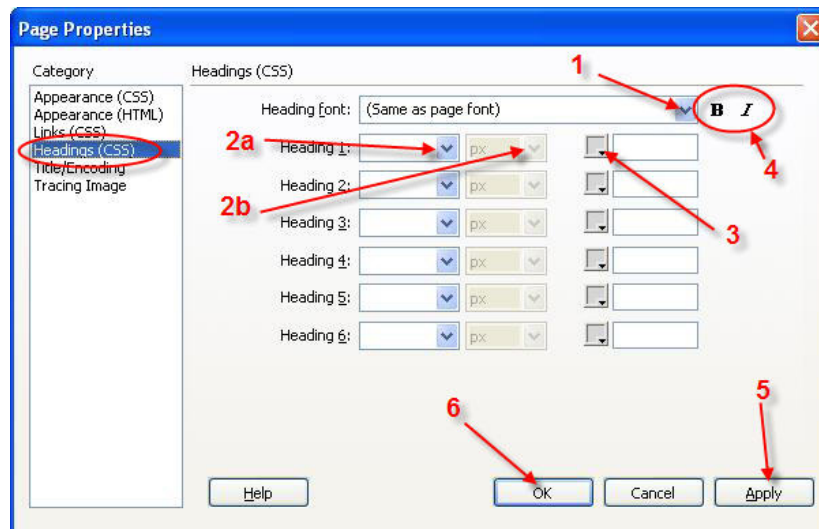

1. Choose an alternate font for your headings if you wish. This setting will override the previous setting made on the appearance tab and apply only to content designated as headings.
2. Choose the font size for each level of heading
 - a. The size is entered here
 - b. The units are chosen here
3. Choose a color for each level heading if you wish
4. You may to make your heading italic. Since headings have a default property of bold, assigning bold here will not effect the heading
5. You may test your settings without closing the window by selecting "Apply"
6. Click the "OK" button to close the window